

Model No. 80.400P (4") Valve & Shower Head Assembly

Note: The shower head is equipped with a built-in flow restrictor which will limit flow of water to 2.0 GPM @ 80 PSI.

Installation Instructions:

1. Determine where valve and shower head will be mounted. The holes shown in the rough-in drawing are the recommended locations when using 27", 1/2" pipe nipple with standard elbow (not furnished). Use thread sealing tape on all threaded connections.
 2. If shower cabinet is to be equipped with a door, mount valve and spray head opposite door hinge whenever possible.
 3. Locate and drill 1-1/4" diameter holes for mixing valve as shown in rough-in, use a 1-1/4" diameter hole saw; 2 holes required.
 4. Determine water supply (i.e. overhead) and position valve accordingly. Place vinyl stem washers onto valve stems, insert valve into holes and secure on inside with flange nut. Place handles on valve stems, secure with mounting screws, cover screw heads with proper H or C hole plug (facing the valve.; hot/left, cold/right). Place 1/2" plug into opposite end of riser hole.
 5. Insert pipe nipple with elbow into valve to locate 1" diameter hole for shower head pipe. Remove pipe nipple and drill hole using a 1" diameter hole saw. Reassemble pipe nipple to mixing valve and install shower head.
 6. Complete installation by connecting hot and cold water supply.
- All pipe fitting connections require 1/2" NPT threads.

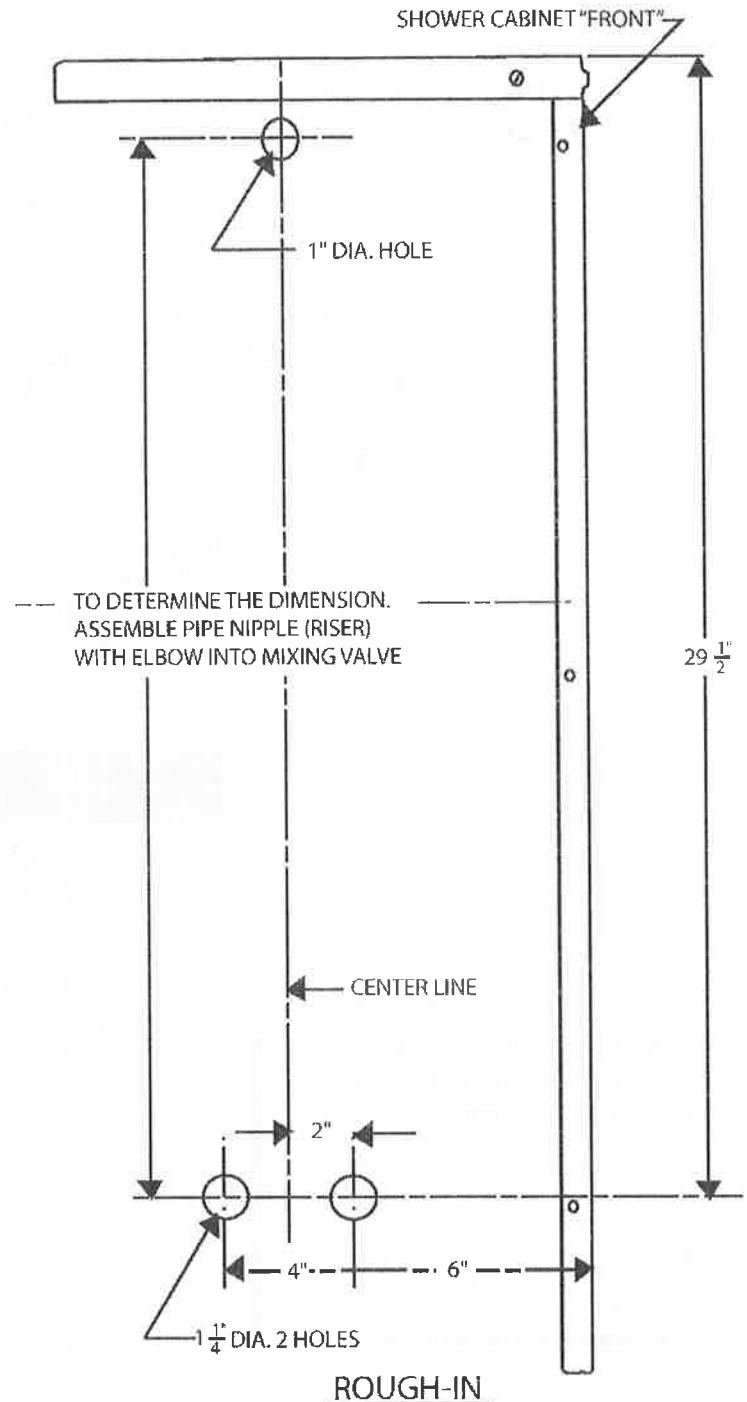

PARTS ILLUSTRATION - MODEL NO. 80.400P (4")

KIT PART NO.
80.402P

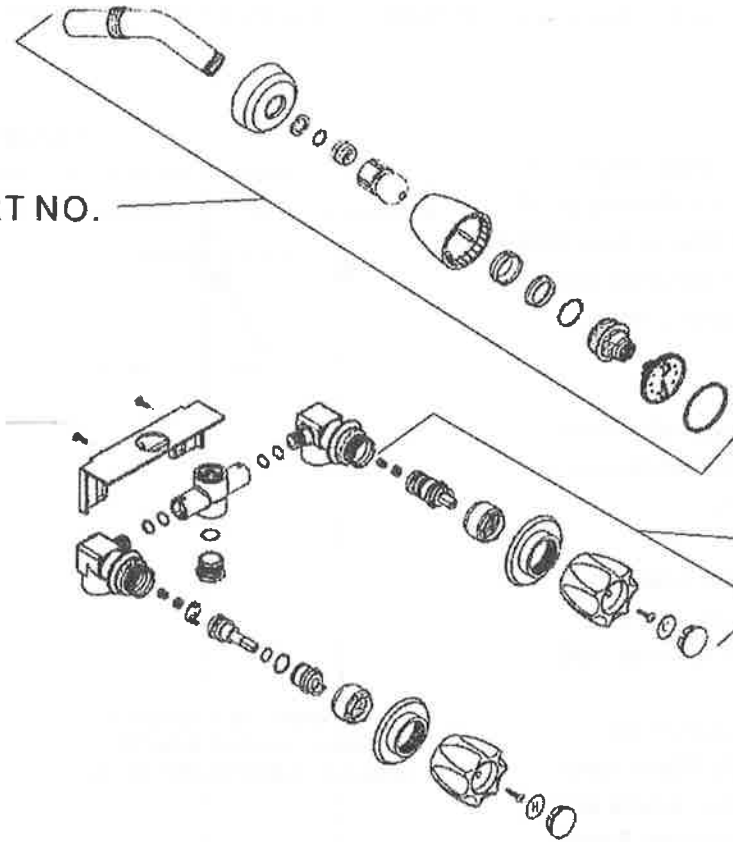

KIT PART NO.
80.401P

Should you have any questions or concerns about the faucet/shower valve please contact us at:

Homewerks Worldwide, LLC
500 Bond Street
Lincolnshire, IL 60069
1-877-319-3757

<u>KIT PART NO. 80.401P</u> <u>VALVE STEM & HANDLE KIT</u>	<u>KIT PART NO. 80.402P</u> <u>SHOWERHEAD KIT</u>
Handle Cover Hot & Cold Button Screw Handle Flange Lock Nut Stem Assembly Stopper Spring	Shower Arm Shower Flange O-rings (4) Aerator Ball Shower Head Clip Washer Seat Front Cover

COMPONENTS SOLD IN KITS ONLY

Effective/Rev Date: Oct. 14, 2014

SI-243 (07-14)